



Image for illustration purposes. Details may vary slightly.

# The Dualex



- Efficient dual occupancy design ideal for investors or owners looking for a second income.
- 3 bedroom design with ample outdoor space and open plan living.
- Kitchen offers custom cabinets with soft-close doors, integrated pantry, and island bench with breakfast bar.
- Customizable layout- view our other versions or mix and match.

### All Ellis Developments homes feature:

- 2.7m ceilings
- 40mm stone breakfast bar bench tops
- Two types of termite protection
- Fujitsu Air
- Security Screens
- Roller Blinds
- Blanco kitchen appliances
- 3 step cornices in living
- Custom cabinets with soft close doors
- Full landscaping, digital irrigation, driveways and fencing

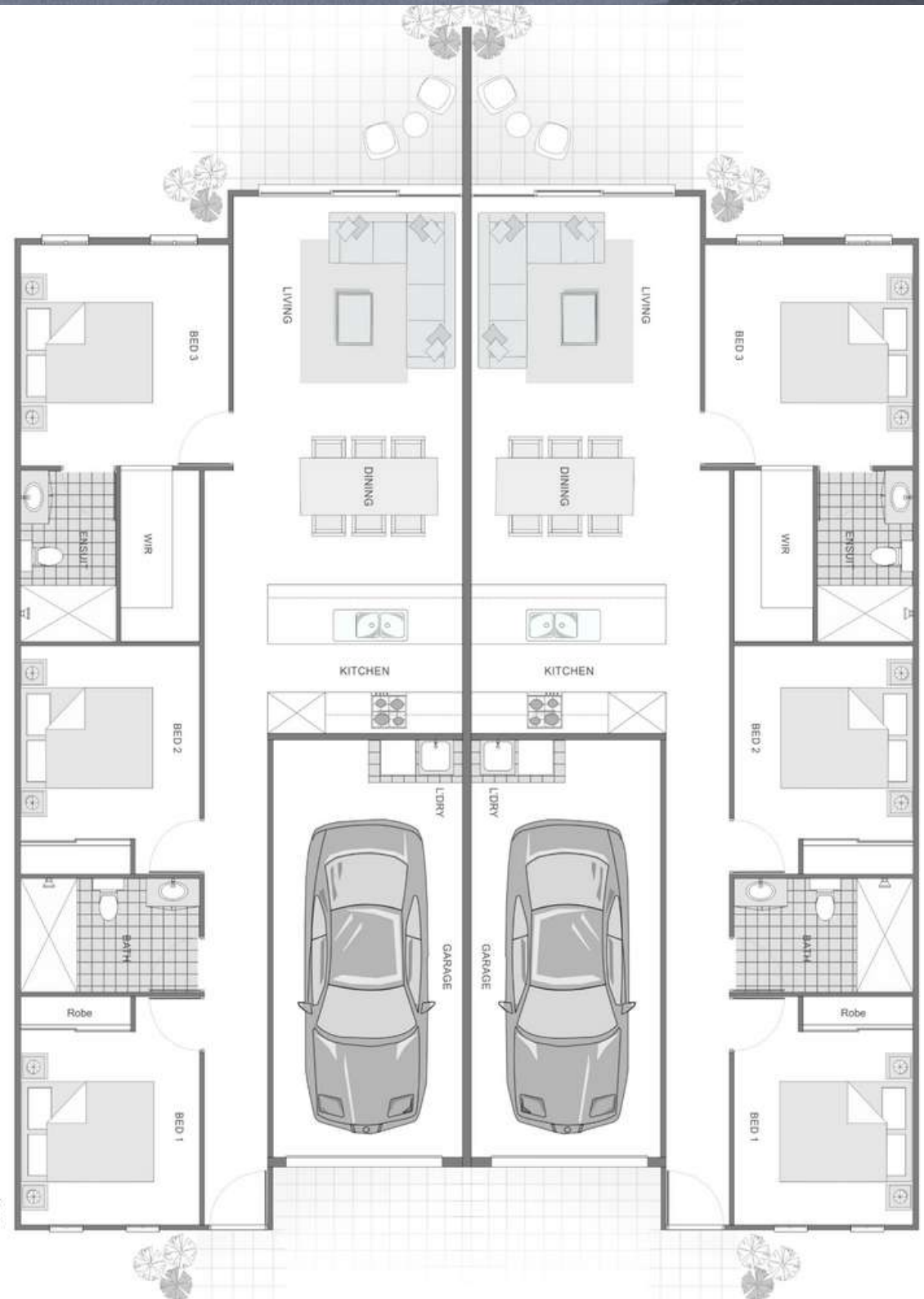

[www.EllisDevelopments.com.au](http://www.EllisDevelopments.com.au)